

SADDLE CREEK PRESERVE OF POLK COUNTY COMMUNITY DEVELOPMENT DISTRICT
RULES RELATING TO PARKING AND PARKING ENFORCEMENT

In accordance with Chapter 190, *Florida Statutes*, and on Tuesday, June 25, 2024 at a duly noticed public meeting, the Board of Supervisors of the Saddle Creek Preserve of Polk County Community Development District (“District”) adopted the following policy to govern parking and parking enforcement on certain District property (the “Policy”). This Policy repeals and supersedes all prior rules and/or policies governing the same subject matter.

SECTION 1. INTRODUCTION. The District finds that parked Commercial Vehicles, Vehicles, Vessels and Recreational Vehicles (hereinafter defined) on certain of its property (hereinafter defined) cause hazards and danger to the health, safety and welfare of District residents, paid users and the public. This Policy is intended to provide for the removal of such Commercial Vehicles, Vehicles, Vessels and Recreational Vehicles from District designated Tow-Away Zones consistent with this Policy and as indicated on **Exhibit A** attached hereto.

SECTION 2. DEFINITIONS.

- A.** *Commercial Vehicle.* Any mobile item which normally uses wheels, whether motorized or not, that (i) is titled, registered or leased to a company and not an individual person, or (ii) is used for business purposes even if titled, registered or leased to an individual person.

- B.** *Vehicle.* Any mobile item which normally uses wheels, whether motorized or not.

- C.** *Vessel.* Every description of watercraft, barge, or airboat used or capable of being used as a means of transportation on water.

- D.** *Recreational Vehicle.* A vehicle designed for recreational use, which includes motor homes, campers and trailers relative to same.

- E.** *Parked.* A Vehicle, Vessel or Recreational Vehicle left unattended by its owner or user.

- F.** *Tow Away Zone.* District property in which parking is prohibited and in which the District is authorized to initiate a towing and/or removal action.

SECTION 3. ESTABLISHMENT OF TOW-AWAY ZONES. Those areas within the District’s boundaries depicted in **Exhibit A**, which is incorporated herein by reference, are hereby established as “Tow Away Zones” for all Commercial Vehicles, Vehicles, Vessels, and Recreational Vehicles (“**Tow Away Zone**”), enforceable subject to the Policy set forth herein.

SECTION 4. TOWING/REMOVAL PROCEDURES.

- A. SIGNAGE AND LANGUAGE REQUIREMENTS.** Notice of the Tow Away Zones shall be approved by the District’s Board of Supervisors and shall be posted on District property in the manner set forth in Section 715.07, *Florida Statutes*. Such signage is to be placed in conspicuous locations, in accordance with Section 715.07, *Florida Statutes*.
- B. TOWING/REMOVAL.** A towing service authorized by Florida law to tow/remove Commercial Vehicle, Vehicles, Vessels and Recreational Vehicles and retained by the District may tow/remove any Commercial Vehicle, Vehicle, Vessel or Recreational Vehicle parked in the Tow Away Zone at the owner’s expense. The Commercial Vehicle, Vehicle, Vessel or Recreational Vehicle shall be towed/removed by the towing service in accordance with Florida law, specifically the provisions set forth in Section 715.07, *Florida Statutes*.
- C. AGREEMENT WITH AUTHORIZED TOWING SERVICE.** The District Manager is hereby authorized to enter into and maintain an agreement with a firm authorized by Florida law to tow/remove unauthorized vehicles and in accordance with Florida law and with the policies set forth herein.

SECTION 5. PARKING AT YOUR OWN RISK. Vehicles, Vessels or Recreational Vehicles may be parked on District property other than the Tow Away Zone pursuant to this Policy, provided however that the District assumes no liability for any theft, vandalism and/ or damage that might occur to personal property and/or to such vehicles.

SECTION 6. AMENDMENTS; DESIGNATION OF ADDITIONAL TOW AWAY ZONES. The Board in its sole discretion may amend these Rules Related to Parking and Parking Enforcement from time to time to designate new Tow Away Zones as the District acquires additional common areas. Such designations of new Tow Away Zones are subject to proper signage and notice prior to enforcement of these rules on such new Tow Away Zones.

EXHIBIT A – *Tow Away Zone (highlighted areas)*

Effective date: June 25, 2024 -

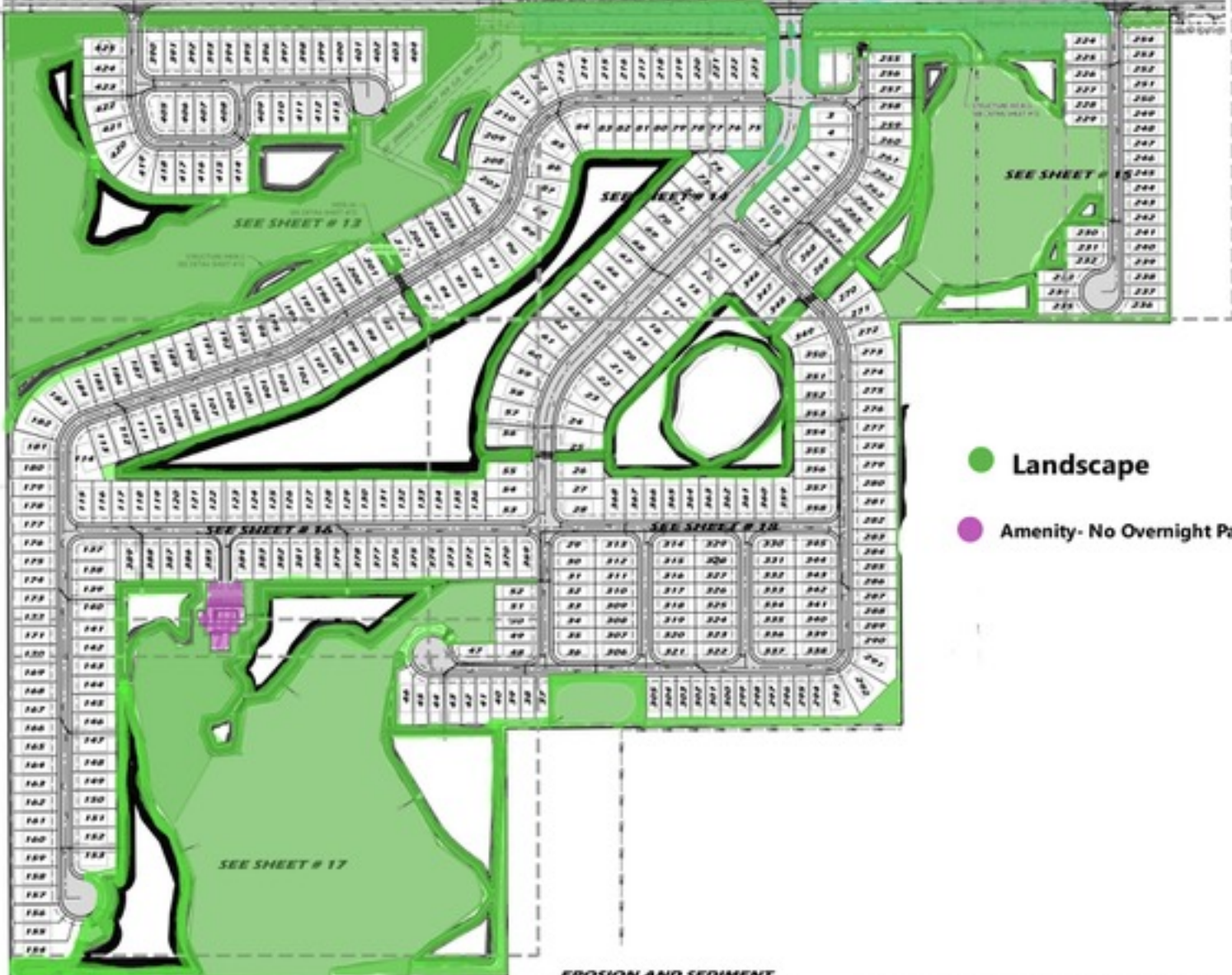

EROSION AND SEDIMENT CONTROL BEST MANAGEMENT PRACTICES FOR POND AND

DRAINAGE NOTE DURING CONSTRUCTION PERIOD EROSION/SEDIMENT